



Commission File No: 9641694

March 25, 2015

Prince Rupert Gas Transmission Ltd.  
450 -1<sup>st</sup> Street SW  
Calgary, Alberta  
T2P 5H1

Attention: Surface Land Administrator

Re: Investigative Permit - Section 14 over Crown Land, Cassiar District  
Within units 51, 52, 63, 72, 73, 83, & 84, Block B, Group 93-M-7.

Date of Issuance: 2015/03/25

Commission File No: 9641694

Applicant File No: 130316 (TSEZAKWA AND WEST BABINE)

## PERMISSIONS

The Oil and Gas Commission ("Commission") hereby authorizes the holder of permit number 9641694, under section 14 of the Land Act, to allow Prince Rupert Gas Transmission Ltd. (the "permit holder") to occupy Crown land within the areas described as Borehole Location, Geophysical Trail and Temporary Access Trail in the attached sketch plan Document No: FOCUS: 130515SK06R1, Sheet 1 and 2 of 2, Revision 1, dated 2014/12/02 as submitted to the Commission in the permit application dated 2014/12/30 (hereinafter referenced together as the "Site"), to conduct appraisals, inspections, analyses, inventories, surveys or other investigations under Authorization Number 947173, subject to conditions set out below.

## CONDITIONS

1. The permit holder may use and occupy the Site only for the purposes of investigating the site for potential oil and gas activities and related activities as defined in the Oil and Gas Activities Act.
2. The total disturbance within the investigative area must not exceed:
  - a. Borehole Location: 1.00 Ha
  - b. Temporary Access Trail: 4.00 Ha
  - c. Geophysical Trail: 4.00 Ha
3. The permit holder will indemnify the Province of British Columbia (the Province) and the Commission against all losses, damages, costs and liabilities arising out of any breach or non-performance of any condition or agreement set out in this Permit and any personal injury, death or property damage occurring within the Site, or happening by virtue of its occupation of the Site, and the amount of such losses, damages and costs shall be payable to the Province or the Commission immediately.
4. The permit holder will immediately effect, and keep in force while this Permit is in effect, insurance of an amount not less than \$1,000,000 protecting the Province, the Commission

and the permit holder (without any rights of cross-claim or subrogation) against claims for personal injury, death, property damage, or third party or public liability claims arising from any accident or occurrence on the Site.

5. The permit holder will restore the site to the satisfaction of the Commission following expiration or cancellation of this Permit.
6. The authorization to occupy and use Crown land does not entitle the permit holder to exclusive possession of the Site. The permit holder will not interfere with any person found on the Site who has a public right of access over the Site or is using the Site pursuant to a prior or subsequent Land Act disposition.
7. The rights granted by this permit are subject to all subsisting grants to or rights of any person made or acquired under the Coal Act, Forest Act, Mineral Tenure Act, Petroleum and Natural Gas Act, Range Act, Water Act or Wildlife Act, or any extension or renewal of the same, any prior dispositions made under the Land Act, and the exceptions and reservations of rights and interests under section 50 of the Land Act.
8. The permit holder will acknowledge and agree that any interference with rights granted under this permit by virtue of the exercise or operation of the rights or interests set out in the Sections (6) or (7) above shall not constitute a breach of the Province's or the Commission's obligations under this permit and the permit holder will release and discharge the Province and/or the Commission from any claim for loss or damage arising directly or indirectly out of any such interference. The permit holder will also agree to pay all costs and expenses that arise out of the permit holder's interference with the rights or interests set out in Sections (6) or (7) and that the permit holder will not commence or maintain proceedings under Section 65 of the Land Act with respect to interference with the permit holder's rights arising out of exercise or operation of the rights set out in Sections (6) or (7).
9. The permit holder must pay to the Province, when due, the Fees to the address and in accordance with the instructions set out in the attached covering letter.
10. The permit holder must not assign or sub-tenure this Permit. The permit holder must not transfer this permit without the Commission's written consent, which consent may be granted or withheld at the Commission's sole discretion.
11. This permit expires two years from the date of issuance.
12. The permit holder must notify the Commission 48 hours prior to commencing construction. Notification must be sent to [C&E@bcogc.ca](mailto:C&E@bcogc.ca).
13. An AIA report must be submitted to the Commission and the Archaeology Branch of the Ministry of Forests, Lands and Natural Resource Operations as soon as practicable.

If artifacts, features, materials or things protected under section 13(2) of the Heritage Conservation Act are identified the permit holder must, unless the permit holder holds a permit under section 12 of the Heritage Conservation Act issued by the Commission in respect of that artifact, feature, material or thing:

- a. immediately cease all work in the vicinity of the artifacts, features, materials or things;
- b. immediately notify the Commission and the Archaeology Branch of the Ministry of Forests, Lands and Natural Resource Operations

- c. refrain from resuming work in the vicinity of the artifacts, features, materials or things except in accordance with an appropriate mitigation plan that has been prepared in accordance with the Heritage Conservation Act and approved by the Commission.
14. No construction activities are authorized in the vicinity of archaeology site GhSp-52 without the issuance of a site alteration permit, pursuant to the terms under Section 12 of the Heritage Conservation Act and as approved by the Commission.
15. Within 60 days of the completion of the clearing phase of the activity authorized, the permit holder must submit to the Commission a Post-construction plan as an ePASS shape file accurately identifying the locations of the overall disturbance within the Site.
16. The permit holder must abide by and comply with all applicable laws, bylaws, orders, directions, ordinances, and regulations of any government authority having jurisdiction in any way affecting its use or occupation of the Site, including, without limitation, the provisions of the Land Act and the provisions of this Permit.

### CUTTING PERMIT AUTHORIZATION

Pursuant to section 47.4 of the Forest Act, the Commission hereby issues Cutting Permit No.26, under Master License to Cut number M02374, Skeena Stikine Forest District, to cut and remove timber from the areas of Crown land within the area within the Site subject to the following conditions:

1. This Cutting Permit expires 2 years from the date of issuance of the Investigative Permit or the revised date should this permit be extended.
2. This Cutting Permit is subject to the terms and conditions in the Master Licence to Cut.
3. All harvested Crown timber must be marked with Timber Mark Number MTB 199.
4. The felling, bucking and utilization specifications in the Master License to Cut apply to this Cutting Permit.
5. Timber that is stored in decks or piles must be marked with the correct timber mark before transportation, or at the end of every shift. The marking must be applied to one end of at least 10% of the timber pieces in each deck or pile using a hammer indentation or paint. Marking must be kept concurrent with decking.
6. In accordance with the Master Licence to Cut referenced above, "Within 60 days of completing operations on a cutting permit, the Licensee shall submit to the Commission a map showing all disturbances that have occurred pursuant to that Cutting Permit, at a scale of 1:20,000 or 1:50,000."
7. The utilization of merchantable timber is not mandatory for this permit.
8. Prior to harvesting, any clearing authorized by this Cutting Permit must be clearly defined on the ground by ribboning or blazing.
9. This permit authorizes a maximum total new cut area within the investigative area of:
  - a. Borehole Location: 1.00 Ha
  - b. Temporary Access Trail: 4.00 Ha
  - c. Geophysical Trail: 4.00 Ha

## CHANGES IN AND ABOUT A STREAM AUTHORIZATION

Pursuant to section 9 of the *Water Act*, the Commission hereby authorizes the permit holder to make changes in and about a stream subject to the following conditions:

1. The approved temporary stream crossing locations on the Crown land are located at:
  - a. UTM locations N. 6131630 E.648938, zone9, NAD 83
  - b. UTM locations N. 6132172 E.648607, zone 9, NAD 83
2. Any substance, sediment, debris or material that could adversely impact the stream:
  - a. must not be allowed or permitted to enter or leach or seep into the stream from an activity, construction, worksite, machinery or from components used in the construction of any works, or
  - b. must not be placed, used or stored within the stream channel.
3. Temporary material, fill, bridge, culvert, pump, conduit, ditch or other structure used to assist in the construction of any works must be constructed and maintained only during the period of construction, and must be removed upon completion of the works.
4. The stream crossing is constructed and maintained at times and in a manner that will not cause serious harm to fish that are parts of a commercial, recreational or Aboriginal (CRA) fishery, as defined under Section 35 of the *Fisheries Act*.
5. During the temporary ford of a stream the authorization holder must ensure that:
  - a. the construction occurs at a time of the year during which the construction can occur without causing harm to fish, wildlife or habitat,
  - b. the 1 in 10 year maximum daily flow over the ford is accommodated without the loss of the ford and without scouring the stream,
  - c. a stream culvert, if used, is designed and installed to pass the average low flow during the period of use,
  - d. the stream channel is protected against erosion during the period of construction and use of the ford, and
  - e. the temporary ford is removed at the end of the period of use at a time, before the next freshet, when the removal can proceed without causing harm to fish, wildlife or habitat.
6. During the construction, maintenance or removal of a clear span bridge, the authorization holder must ensure that:
  - a. the equipment used for construction, including site preparation, maintenance or removal of the bridge, is situated in a dry stream channel or is operated from the top of the bank,
  - b. the bridge and its approaches do not produce a back water effect or increase the head in the stream,
  - c. the hydraulic capacity of the bridge is equivalent to the hydraulic capacity of the stream channel and the height under the bridge will provide free passage of flood debris, and
  - d. the bridge material meets the standards of the Canadian Standards Association, as applicable.
7. During the installation, maintenance or removal of a stream culvert for crossing a stream, the authorization holder must ensure that:

- a. the equipment used for site preparation, construction, maintenance or removal of the culvert is situated in a dry stream channel or operated from the top of the bank,
  - b. in fish bearing waters, the culvert allows fish in the stream to pass up or down stream under all flow conditions,
  - c. the culvert inlet and outlet incorporate measures to protect the structure and the stream channel against erosion and scour,
  - d. if debris cannot safely pass, provision is made to prevent the entrance of debris into the culvert,
  - e. the installation, maintenance or removal does not destabilize the stream channel,
  - f. the culvert and its approach roads do not produce a backwater effect or increase the head of the stream,
  - g. a culvert having an equivalent diameter of 2 metres or greater, or having a design capacity to pass a flow of more than 6 cubic metres a second, is designed by a professional engineer and is constructed in conformance with that design,
  - h. the stream channel, located outside the cleared width, is not altered,
  - i. embankment fill materials do not and will not encroach on culvert inlets and outlets,
  - j. the culvert material meets the standards of the Canadian Standards Association.
8. During the restoration of a change in and about a stream, the authorization holder must ensure that:
- a. any structures constructed to cross the stream are removed,
  - b. the channel is restored to its natural state, to the extent practicable,
  - c. the site of the crossing and associated approaches (including cut and fill slopes and ditch lines) are restored by:
    - i. stabilizing any waste materials removed from the site to above the high water mark to prevent them from entering the stream,
    - ii. re-vegetating disturbed areas associated with the crossing using seed or vegetative propagules of an ecologically suitable species,
    - iii. redistributing coarse wood debris in a manner that aids soil stabilization, and
    - iv. ensuring that surface drainage associated with approaches will not transport sediments into the stream.
9. Stream crossing methods must be selected and/or constructed in accordance with the Environmental Protection and Management Guidebook, including the Best Management Practices outlined therein.
10. Stream crossing activities must not prevent the movement of fish, nor impede the movement of fish to the extent that it is harmful to the survival of the fish.

#### **ADDITIONAL CONDITIONS**

1. The Permit holder must notify Lake Babine Nation prior to the commencement to any activities.
2. The Permit Holder must notify Yekooche First Nation prior to the commencement to any activities.
3. The Permit holder is not authorized to complete any works within Research Installation EP0657.06.
4. No borehole is to be located within any watercourse, wetland or lake.

The attached plan(s) form an integral part of this authorization.

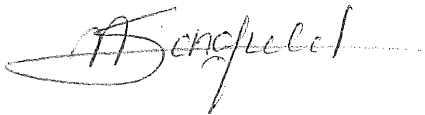
A handwritten signature in black ink, appearing to read "M. Schofield", with a large, stylized loop at the beginning.

Madison Schofield  
Natural Resource Officer

pc: Lake Babine First Nation  
pc: Yekooche First Nation  
pc: Roy Northern Land and Environment



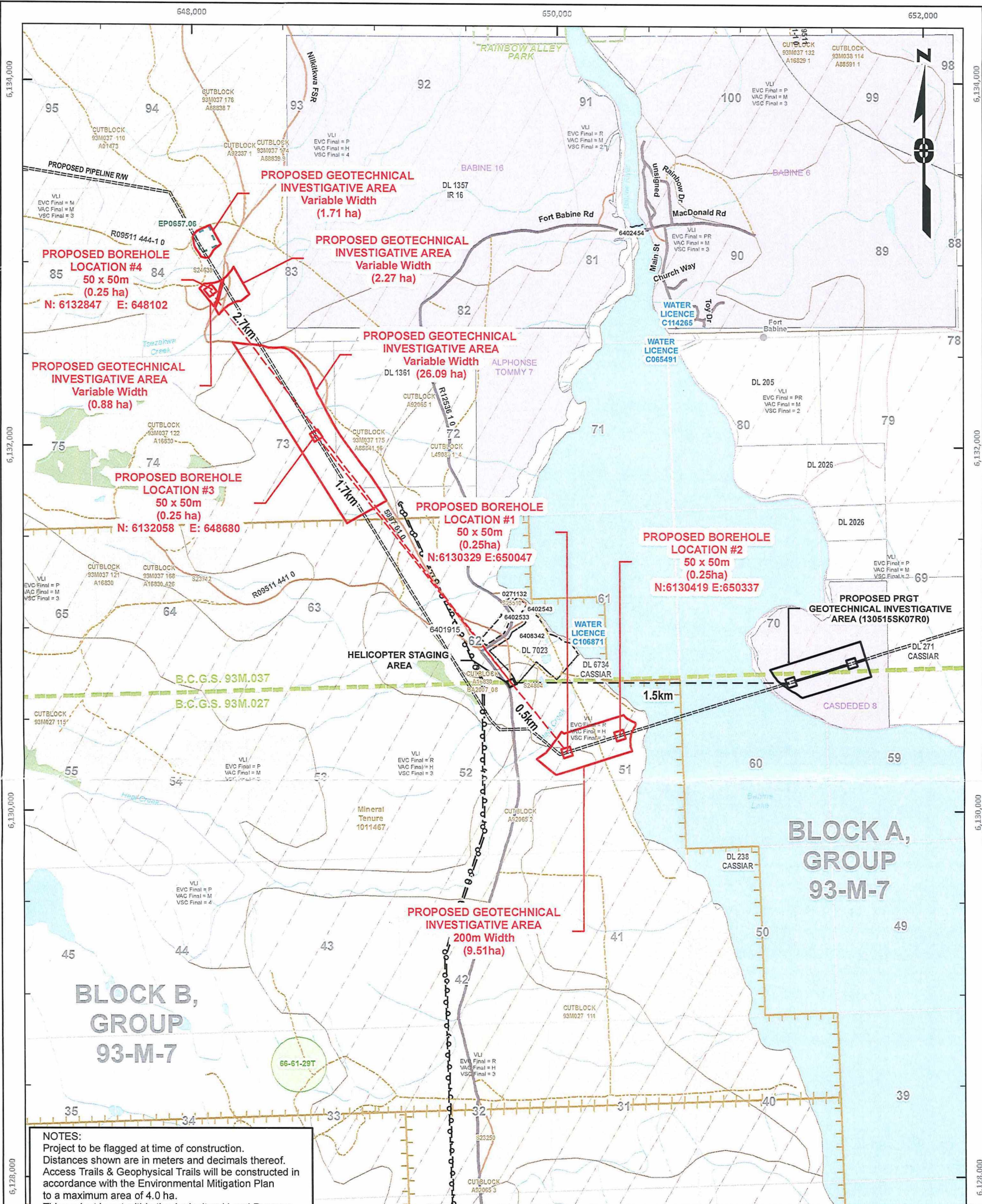

NOTES:  
Project to be flagged at time of construction.  
Distances shown are in meters and decimals thereof.  
Access Trails & Geophysical Trails will be constructed in accordance with the Environmental Mitigation Plan to a maximum area of 4.0 ha.  
This project is not within the Agricultural Land Reserve.

Land Use Plans Within Proposed Project: (Note: data not shown on mapping)  
- Bulkley Land and Resource Management Plan

Prince Rupert  
Gas Transmission Project



## PRINCE RUPERT GAS TRANSMISSION LTD.

B.C.G.S SKETCH SHOWING  
**PROPOSED GEOTECHNICAL INVESTIGATIVE PROGRAMS  
(WEST BABINE LAKE CROSSING) AND  
(TSEZAKWA CREEK CROSSING)**  
WITHIN UNITS 51, 52, 63, 72, 73, 83 & 84, BLOCK B, 93-M-7



B.C.G.S.: 93M.027/037

SCALE 1:20,000  
(NAD 1983 UTM ZONE 9N)



JOB NO.: 010042349	REVISION
FILE NO.: 130515BC06R1_SK06R1.mxd	ePASS: 10049883
CLIENT FILE NO.:	DRAWN BY: RS / JDB
AFE:	CHECKED: NAR
REF NO.: 130515SK06R1	LAND NO.:
DATE: Dec. 2, 2014	SHEET: 1 of 1

<b>PROJECT FEATURES</b> Proposed Features Previously Proposed Features Investigative Area Centreline Geophysical Trail Proposed PRGT Pipeline R/W Temp. Access Trail Helicopter Flight Path OIL AND GAS Ground Disturbance/ Leases Pipeline CROWN TENURES Watershed Reserve Waterpower Windpower Agriculture Env. Conserv. & Rec. Industrial Communication Utility Transport Electric Power Line Quarrying	<b>TRANSPORTATION</b> Highway Paved Road Highgrade Gravel Lowgrade Gravel Winter Road Cutline/Trail Forestry Road Railway Abandoned ENVIRONMENTAL Permanent Sample Plot Muskwa-Kechika Management Area Protected Area/ Ecological Reserve Provincial Park Recreation Area Vehicle Closure Area Research Installation	<b>MUNICIPAL</b> Municipality Large Municipality First Nations Reserve Crown Parcel Private Parcel FORESTRY Cutblock Forest Cover Reserve Community Forests Old Growth Management Area Woodlots Tree Farm License WATER FEATURES Lake, River, Canal, Lagoon, Dugout Stream, Canal, Oxbow, Ditch	<b>MISCELLANEOUS</b> Coal Tenure Mineral Tenure Mineral Reserve VLI - High VLI - Moderate VLI - Low Recreation Protected Grazing Tenure Agricultural Land Reserve Ungulate Winter Range Wildlife Habitat Area
---	---	--	--

DISCLAIMER: All rights reserved. This map contains confidential and proprietary information. Data contained herein is compiled and confirmed from many sources (private and public), including (but not limited to) Forest MapView and iMapBC. It is subject to change without notification and is provided on an "as is" basis. Focus Surveys (BC) Limited Partnership and its employees take no responsibility for the accuracy or completeness of this information. Content should be reviewed and verified by users.

9641694